



Active  
Noise cancelling



#### User Manual

Please read this Manual before setting up Sonic 10W Headphone and stick to its requirements strictly for Safety reason. Suggest you save this manual for further inquiries reference.

SONIC 10W

2017 PeopleLink Unified Communications Pvt. Ltd. All rights reserved.  
PeopleLink Unified Communications Pvt. Ltd.  
Q3-A3, 10th Floor, Cyber Towers, Hitech City  
Madhapur, Hyderabad – 500081 India

No part of this document may be reproduced or transmitted in any form or by any means, electronic or mechanical, for any purpose, without the express written permission of PeopleLink. Under the law, reproducing includes translating into another language or format. As between the parties, PeopleLink, retains title to and ownership of all proprietary rights with respect to the software contained within its products.

Therefore, you must treat the software like any other copyrighted material (e.g., a book or sound recording). Every effort has been made to ensure that the information in this manual is accurate. PeopleLink, is not responsible for printing or clerical errors. Information in this document is subject to change without notice.

#### Usage Instruction

- (1) Don't attempt to disassemble the unit and change any part, except there is operation method mentioned in the manual.
- (2) Don't expose the unit to liquid, moisture or humidity, since it is not a waterproof product.
- (3) Disconnect the unit with your BT device and move it to the safe area if the liquid get inside the unit.
- (4) Don't assemble or disassemble the unit to avoid electric shock, if there is water on your hands.
- (5) Don't expose the unit to extremely high temperature or dispose of the unit in fire as it will result in an explosion.
- (6) Don't place the unit in an electromagnetic interference environment to avoid malfunction.

#### Packing list

Headphones	X 1
User manual X 1	X 1
3.5mm AUX line	X 1
Charging cable	X 1

#### Product specification

- BT version : V5.0
- Battery capacity : 400 mAh
- Charging time : About 2.5 hours
- Transmission distance :  $\geq 10$  meters
- Horn impedance :  $32 \Omega \pm 15\%$
- Frequency range : 20 Hz-20KHz
- Speaker size : 40 mm
- Playing time : About 15 hours
- Rated input : 5V  $\approx 350$ mA
- Audio interface : AUX
- SNR : 115dB  $\pm 3$ dB
- Microphone sensitivity : -38dB  $\pm 3$ dB
- ANC depth : -25dB  $\pm 3$ dB

(All technical information is subject to actual performance)

#### Product schematic description

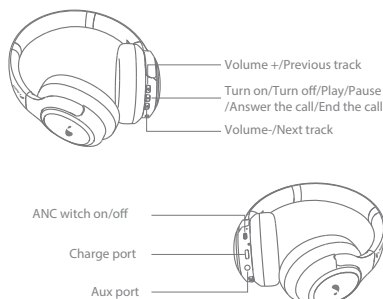

#### Operating instruction

##### 1. Turn on/Turn off

- When the earphones is in turn off states, long press the button for 3 seconds to start the earphone.
- When the earphones is in turn on states, long press the button for 3 seconds to power off the earphone.

##### 2. BT pairing

- Step 1: When the earphones is in turn off states, long press the button for 3 seconds to start the earphone.
- Step 2: Open the smart device BT list, search and find "PeopleLink Sonic OE10W", click it to connect.

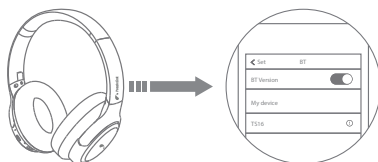

##### 3. Switch on/off ANC mode

- When the earphones is in non ANC mode, put the switch button up to open the ANC mode.
- When the earphones is in ANC mode, put the switch button down to off the ANC mode.

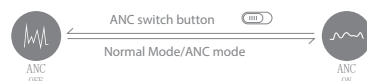

Reminder: After using the headset, please turn off the headphone, meanwhile switch the ANC noise reduction button to the "ANC off" side to avoid running out of power

##### 4. During the music playing

- Single Click: Volume up
- Long press 2 seconds: Previous track
- Single click: Volume down
- Long press 2 seconds: Next track
- Single click: Play/Pause

##### 5. Phone hands-free

- Single click: Answer the call/End the call
- Click twice: Rewind the phone
- Long press 2 seconds: Reject the call

#### LED light introduction

Turn on	Red and blue LED light flash alternately
Turn off	Red and blue LED light die out
ANC mode	Green LED light normally on
ANC shut off	Green LED light die out
Reconnect	Red and blue LED light flash alternately
Bluetooth connected	Red and blue LED light die out
Search the Bluetooth device	Red and blue LED light flash alternately
Bluetooth disconnect	Red and blue LED light flash alternately
Earphones charging	Red LED light normally on
Earphones fully charged	Red LED light die out
Battery low prompt	Red LED light flash 1 time every 10 seconds.